

User Manual

Portable Automotive Relay Tester
12V/24V 2-in-1

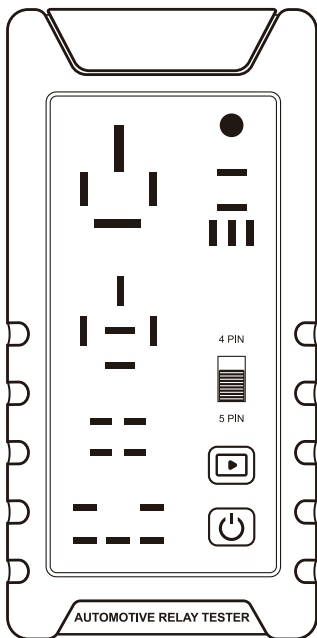

Contents

Safety Precautions	01
1. Product Overview	02
1.1 Panel Parsing	02
1.2 Parameter Information	03
2. Product Features	04
2.1 Product Introduction	04
2.2 Procedure	04
2.2-1 Step 1	04
2.2-2 Step 2	04
2.2-3 Step 3	05
2.2-4 Step 4	05
2.2-5 Step 5	07
2.3 Automatic Power Off	08
2.4 Indicator Function Definition	08
3. Warranty and Service	08

! Safety Precautions

This manual includes instructions for using the equipment and operation methods, in order to prevent personal injury and damage to the vehicle or relay detector, please read this user manual care-fully first, and observe the following safety precautions when operating the vehicle:

- 1** Electrical equipment or rotating engines can cause particles to splash.
- 2** Wear safety goggles that comply with ANSI standards, as flying particles can cause eye discomfort or injury.
- 3** Be careful of the explosion of the battery, the ignited gas may cause personal injury.
- 4** Always use a sturdy, healthy, fully charged battery as a power source.
- 5** Do not place the battery near sparks and flames, nor near parts that generate heat, to avoid an explosion.
- 6** Always follow the warnings, admonitions, and maintenance instructions in the vehicle maintenance manual.
- 7** After the test is complete, all relays should be properly removed from the tester.
- 8** After the test is completed, do not touch the feet of the relay immediately, it will get hot during the test, cool down for at least five minutes before contacting.

1. Product Overview

The device is a professional relay tester that can test 12V/24V relays in 5 different pin positions and automatically identify them to indicate the general health and function of common automotive relays.

The device is able to detect the relay coil to check if the relay contacts are working properly. Observe the pin configuration and the time of the contacts to close and open, if the device light up a green LED which means pass test, otherwise a red LED will be light up.

1.1 Panel Parsing

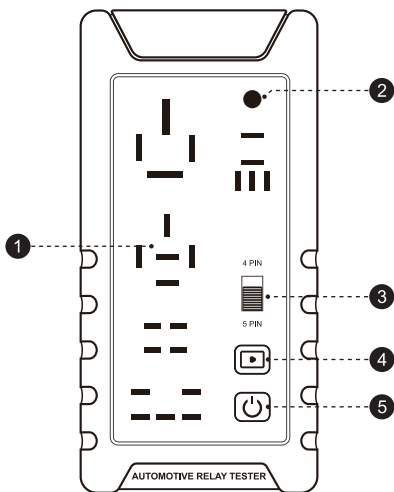

- 1 **Relay Pin:** 4 Pin/5 Pin relay.
- 2 **LED Indicator:** Device Status Indication.
- 3 **Toggle Switch:** 4-Pin/5-Pin relay switch.
- 4 **Test Keys:** Press to start test process.
- 5 **ON/OFF Key:** Turn ON/OFF the device.

1.2 Parameter Information

Project	Description
Product Name	Automotive Relay Tester
Test Scope	4PIN/5PIN Common Relays
Product Color	Black
Device Material	ABS Material
Type of Test	12V/24V Automotive Relays
Power Supply Mode	3pcs AA Batteries/Type-C Powered
Operating Temperature	-10°C~40°C (14°F~104°F)
Storage Temperature	-20°C~50°C (-4°F~122°F)

2. Product Features

2.1 Product Introduction

The device is mainly used to check whether the automotive relay is working properly, and it switches several times during each test as it observes the consistency of each cycle. It will provide a general health and functional indication of the relay switch contacts and coils, and the device will also check the control side of the relay by applying a signal to the relay coil while checking that the relay contacts are working properly.

The test result will be displayed by LED indicator. If the relay is working properly, the green LED light will turn on, or the red LED light will light up.

2.2 Procedure

2.2-1 Step 1

1. Place 3pcs AA batteries into the device (corresponding to the instructions), the positive "+", the negative "-", please note the battery should not be inverted.

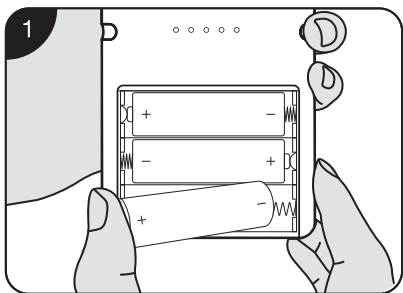

2.2-2 Step 2

2. After installing the battery, press the play button to start the test.

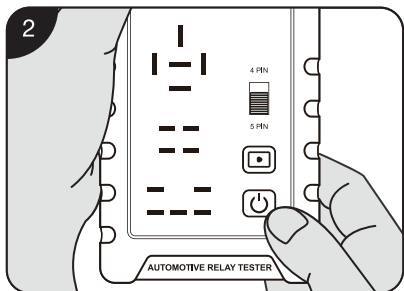

2.2-3 Step 3

3. Before the relay is inserted into the tester, please check the relay pins. If it is a 4pin relay, select "4-PIN" on the tester or "5PIN" on the tester if it is a 5pin relay.

Note: If there is a special pin position, it might not testable.

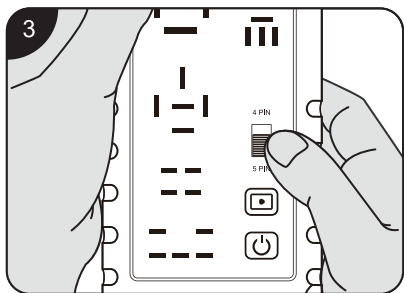

2.2-4 Step 4

4. Select the corresponding pin setting, insert the relay, press the "test" button, the device will automatically identify the 12V/24V relay, then the device will open and close 20 times of detection actions, After the testing process is complete, the buzzer will sound to indicate completion.

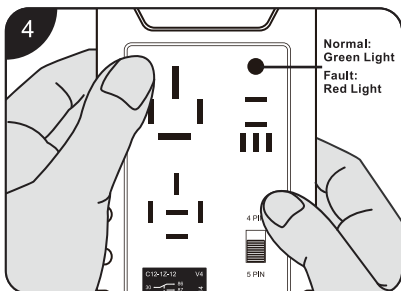
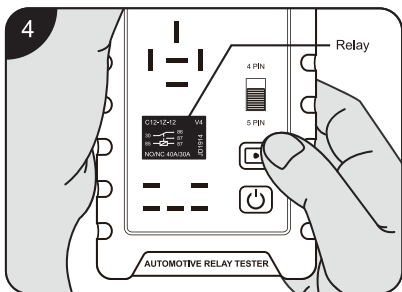

Note: After the beep ends, the red LED light indicates that the relay is faulty, while the green LED light indicates the relay is normal.

Do not test multiple relays at the same time to avoid conflict.

2.2-5 Step 5

5. Long press the "Power" button to power off relay tester then remove the relay from the tester.

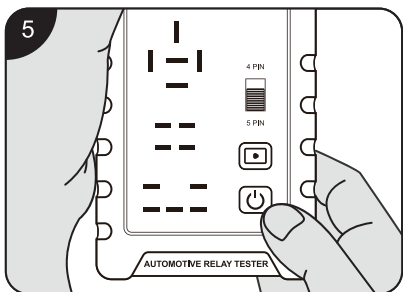

Note: Always use a strong, healthy, fully charged battery as a power source. When the device applies a high test current to the battery with a weak battery power, the test results might be inaccurate.

Note: If, during the test, you see a solid red LED, the supply voltage has dropped too low to support the current demand of this device. In this case, find a stronger battery to power the tester.

Note: Regardless of whether the relay pin position is normally open or normally closed, as long as the pin position is correct, it can be tested.

2.3 Automatic Power Off

The device will automatically shut down when there is no operation over 1 minute to saving battery power.

2.4 Indicator Function Definition

Status Indication:

LED Lights	Buzzer	State
The Green Light is On	A Tick	Readiness/The Test is Normal
The Red Light is On	Beep for Two Seconds	Wrong Foot Position Selection/Faulty Relays
The Green Light is On	A Tick	Boot
Extinguish	A Tick	Shutdown

Battery Indication:

Sufficient Power: The green indicator lights up in standby mode, and the test ready state is entered.

Low Battery: The green indicator lights up in standby mode, and the buzzer beeps twice every 5 seconds to enter the test-ready state.

Insufficient Battery: The red indicator light is always on, the button cannot be operated for testing, and the buzzer will ring for 3 seconds.

Please Note: The battery level indicator only works when 3pcs AA Batteries Powered are powered, and the default battery level indicator is sufficient when the Type-C power supply is powered.

3. Warranty and Service

Hello! Thank you for purchasing our products, in order to better serve you, please read carefully and fill in correctly and save this warranty card.

Name			
Telephone			
E-mail			
Purchase Date		Product Model	
Order Number			
Shipping Address			
Maintenance Record	Date	Failure Causes and Solutions	

※ **Warranty Statement:**

If the product with any quality issues needs to repair, please send this warranty card together with the purchased product back to our company for aftersales service.