

**SAFETY WARNING**

- Never pull out or insert the spark plug with the power supply connected. Prior to any manipulation, make sure to turn off the power.
- High voltage! Avoid touching the spark plug with bare hands to prevent injury.

**PRODUCT DESCRIPTION**

**01**

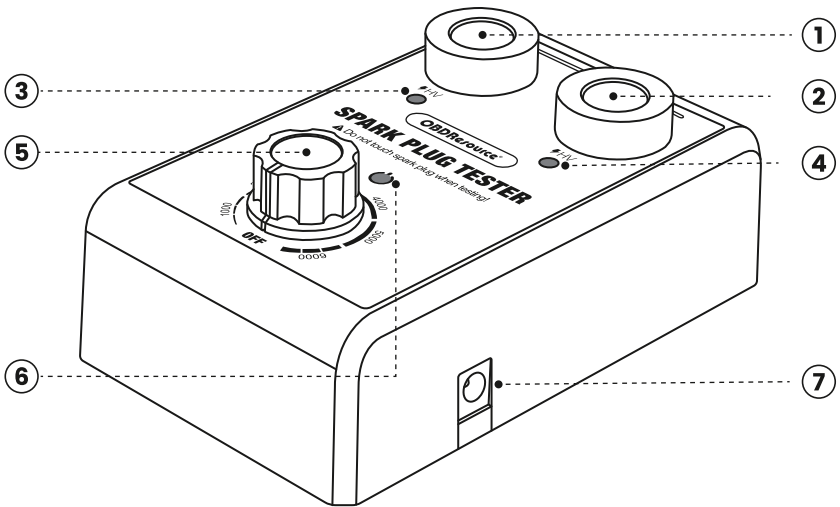

- |                                      |                                      |                     |
|--------------------------------------|--------------------------------------|---------------------|
| <b>1</b> Spark Plug Socket           | <b>4</b> HV (High Voltage Indicator) | <b>7</b> Power Port |
| <b>2</b> Spark Plug Socket           | <b>5</b> Switch                      |                     |
| <b>3</b> HV (High Voltage Indicator) | <b>6</b> Power Indicator             |                     |

**Note:**

If the spark plug cannot reach the negative cylinder iron, use a shim for testing. It is only necessary to use it if the negative cylinder iron cannot be contacted, not for every test. [\*spark plugs that do not require shims will cause normal spark plugs to not work if used.]

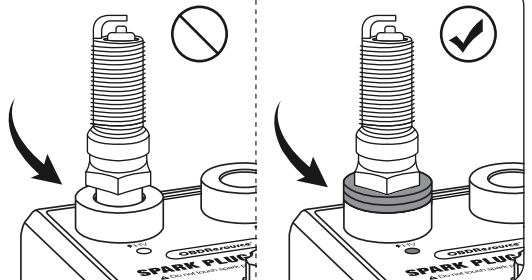

1

Please insert the black card for better observe the ignition status of the spark plug before operating.

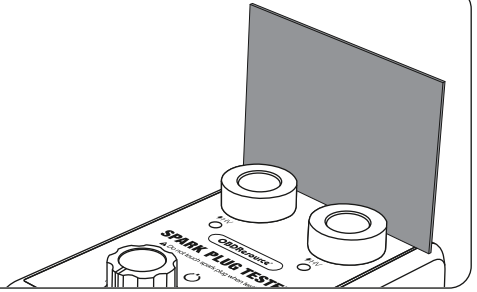

2

Insert the spark plug into either tester socket ① or ② .

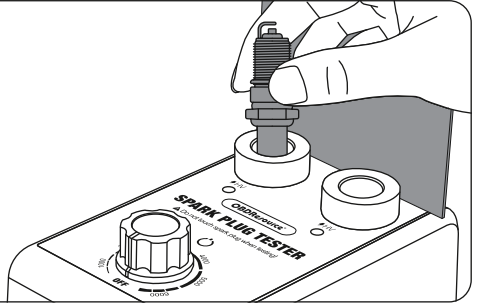

3

Insert the spark plug into the tester socket, then plug in the adaptor and connect the tester to the power supply.

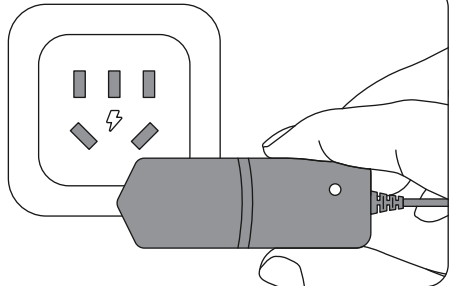

4

Turn switch ⑤ clockwise to power on the tester. Indicator ⑥ will light up red.

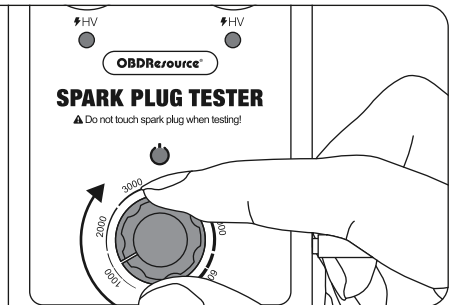

5

Turn switch ⑤ clockwise to adjust the working frequency between 1000rpm to 6000rpm/ min for stronger spark strength.

